

PORODO
LIFESTYLE



Porodo Lifestyle

**Quick Flip 3-In-1 Air Fryer
Grill and Hot Pot**

SKU: PDLFST209BK

Table of Contents

Safety Guide	2
Before First Use	4
Quick Guide	5
Product Components	5
Specifications	6
Warnings	6
Accessories	7
Using the Accessories	7
Control Panel Guide	8
Cooking Guide	9
Operation Instructions	10
Timer and Temperature Setting	11
DIY Cooking Guide	11
Grill or Hot Pot Instructions	12
Pause the Operation	12
Cooking Table	12
Cleaning and Maintenance	13
Caution	13
Storing	14
Disposal	14
Warranty	15
Contact Us	15

Safety Guide

1. This appliance is suitable for use by children aged 8 and older, as well as individuals with physical, sensory, or mental limitations, provided they have received proper instructions on its safe operation and are aware of the potential risks.
 2. The appliance should not be used by individuals (including children) with reduced physical, sensory, or mental capabilities, or by those lacking experience or knowledge unless under supervision or instruction. Children must not be allowed to play with the appliance.
 3. Maintenance and cleaning of the appliance should not be performed by children unless they are over 16 years of age and under supervision.
 4. Ensure the appliance is kept out of the reach of children under 16 years old.
 5. This appliance is intended for use in household environments and similar settings, such as: Kitchens in professional environments (e.g., shops, offices), Farms, Hotel or motel rooms and other residential-like environments, and Guest rooms or similar spaces.
- Attention:** This appliance cannot be operated with an external timer or a separate remote control.
6. Read all instructions before use.
 7. Before use, ensure that the voltage indicated on the rating label matches the local power supply voltage before connecting the appliance to the mains.
 8. Do not allow the power cord to rest on a hot surface or hang over the edge of a table or countertop.
 9. If the power cord is damaged, it must be replaced by a qualified technician to avoid hazards, or the appliance should be sent to an authorized after-sales service center for repair.
 10. Close supervision is necessary when the appliance is used near or by children.
 11. The use of non-recommended accessories or those not sold by the manufacturer can result in fire, electrical shock, or injury.

- 12.** Always unplug the appliance when not in use, before assembling or disassembling any parts, and before cleaning. Turn all buttons and knobs to the "Off" position and unplug the appliance by grasping the plug (never by pulling the cord).
- 13.** Do not leave a working appliance unattended.
- 14.** Never place the appliance near a gas stove, electrical stove, or any other source of heat where it may come into contact with a hot surface.
- 15.** The appliance should only be used with the provided stand.
- 16.** Do not use the appliance outdoors.
- 17.** Only use the appliance for its intended purpose.
- 18.** Always use the appliance on a stable, dry, and level surface.
- 19.** The appliance is for domestic use only. The manufacturer is not responsible for accidents caused by improper use or failure to follow the instructions in this manual.
- 20.** All repairs should be carried out by the manufacturer or an authorized after-sales service.
- 21.** Never immerse the appliance, cord, or plug in water or any other liquid.
- 22.** Ensure that children do not touch the appliance or cord.
- 23.** Keep the cord away from sharp edges, hot parts, and other heat sources.
- 24.** Before use, remove all packaging materials and promotional stickers.
- 25.** Never leave the appliance unattended while it is in use.
- 26.** Do not use or store the appliance outdoors.
- 27.** Use the appliance only for its intended purpose.
- 28.** Check that the voltage and frequency of the power supply match the indications on the appliance's rating label.
- 29.** The plug must be inserted into an appropriate outlet that is installed and grounded according to local standards and requirements.
- 30.** Only use the utensils provided with the appliance.
- 31.** Do not operate the appliance with a damaged cord or plug. If the appliance malfunctions or is damaged in any way, return it to the Service Department or an authorized service agent for inspection, repair, or any necessary adjustments. Do not attempt to repair the appliance yourself.

- 32.** To prevent electrical shock or burns, do not immerse the unit, cord, or plug in water or any other liquid.
- 33.** Do not operate the appliance with wet hands.
- 34.** Fully unwrap the cord to prevent overheating.
- 35.** Do not let the power supply cord hang over the edge of a countertop or come into contact with hot surfaces.
- 36.** Ensure the power cord does not run underneath or around the unit.
- 37.** Never pull the cord or appliance to disconnect the plug from the socket.
- 38.** Do not use the appliance if there is any water inside or if parts are still wet after cleaning.
- 39.** Never operate the appliance without ingredients.
- 40.** Handle sharp accessories, such as knives, with extreme care. Only touch accessories after they have completely stopped moving inside the appliance.
- 41.** Failure to maintain the appliance in a clean condition can adversely affect its lifespan and may pose a safety hazard.
- 42.** Any injury or damage caused by failure to follow these instructions is at your own risk. Neither the manufacturer, importer, nor the supplier can be held liable.
- 43.** Save these instructions for future reference.

Before First Use

Step 1: Carefully unpack the unit and remove all packaging materials. Place the unit on a flat, heat-resistant, non-flammable surface. Do not immerse the appliance in water or any other liquid.

Step 2: Wipe the unit with a soft, damp cloth and dry thoroughly.

Note: When using the appliance for the first time, a slight odor may be emitted. This is harmless and will disappear after a few minutes. The odor is due to protective oil applied to prevent friction during transportation.

Quick Guide

Step 1: Ensure the Air Fryer is switched off and unplugged from the mains power supply.

Step 2: Place the Air Fryer on a flat, stable, heat-resistant surface at a comfortable height for the user.

Step 3: Pull the glass container out of the Air Fryer using the handle. Place the mesh rack into the glass container, then add the food onto the rack.

Step 4: Insert the glass container back into the Air Fryer.

Step 5: Plug the power cord into the socket and set your desired cooking time and temperature.

Step 6: Once cooking is complete, switch off the Air Fryer at the mains power supply.

Step 7: Ensure the unit is not turned on without any food inside.

Product Components

1. Digital Control Dial

2. Head

3. Detachable Glass Jug

4. Jug Handle

5. Air Outlet

6. Release Button

7. Mesh Rack

8. Grill Pan

9. Soup Pot

10. Glass Lid



Specifications

Rated Voltage	220-240V
Rated Frequency	50/60Hz
Rated Power	1200-1400W
Capacity	4.5L
Power Cord	UK 3-Pin Plug
Product Size	285 x 280×290mm
Product Weight	6.30 kg
Model Number	LFS209

Warnings

Warning: The following illustrates the correct method for using the Air Fryer.

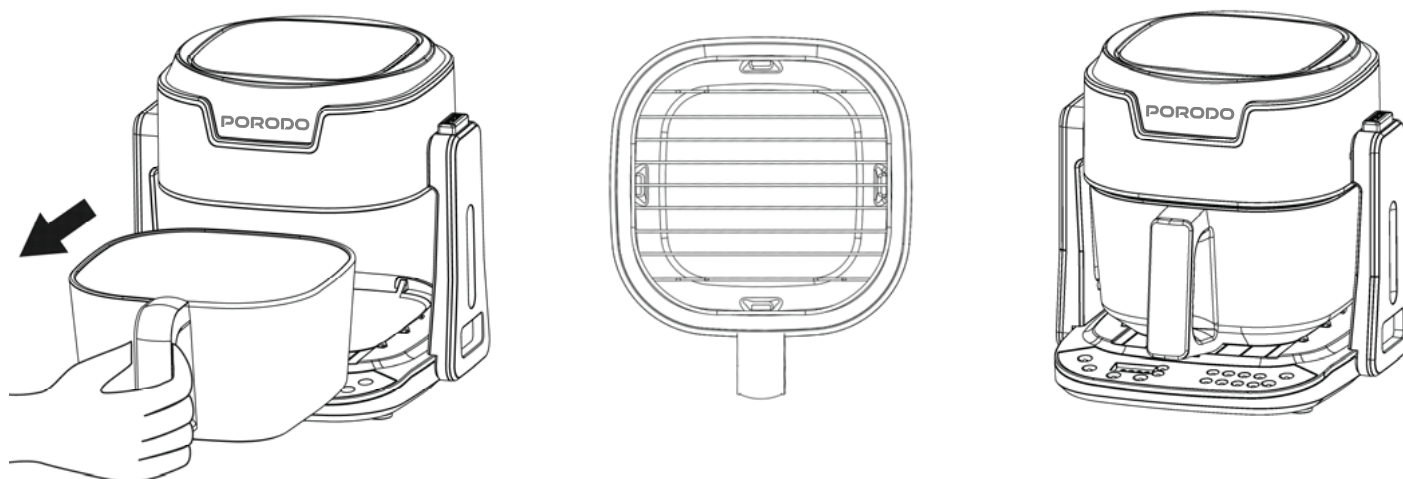

Warning: Before use, please remove the paper holder inside the unit.

Accessories

1. Included

Mesh Rack

Grill Pan

2. Optional Accessories (Not Included):

Soup Pot

Glass Lid



Mesh Rack



Grill Pan



Soup Pot



Glass Lid

Item	Description
Mesh Rack	For holding food such as fries, chicken wings, etc.
Grill Pan	For grilling steak, salmon, fish, etc.
Soup Pot	For making hot pot and soup.

Using the Accessories

1. Using the Mesh Rack for Fries and Chicken Wings:

When using the air fryer, first pull the glass container out of the unit. Then, place the mesh rack and food inside the glass container.

Afterward, carefully push the glass container back into the air fryer.



(1)



(2)



(3)

2. Using the Grill Pan for Steak:

When using the appliance as a grill, first pull the glass container out of the air fryer. Then, press the button on the right-side panel and turn the head upside down. After that, you can place the grill pan on the unit.

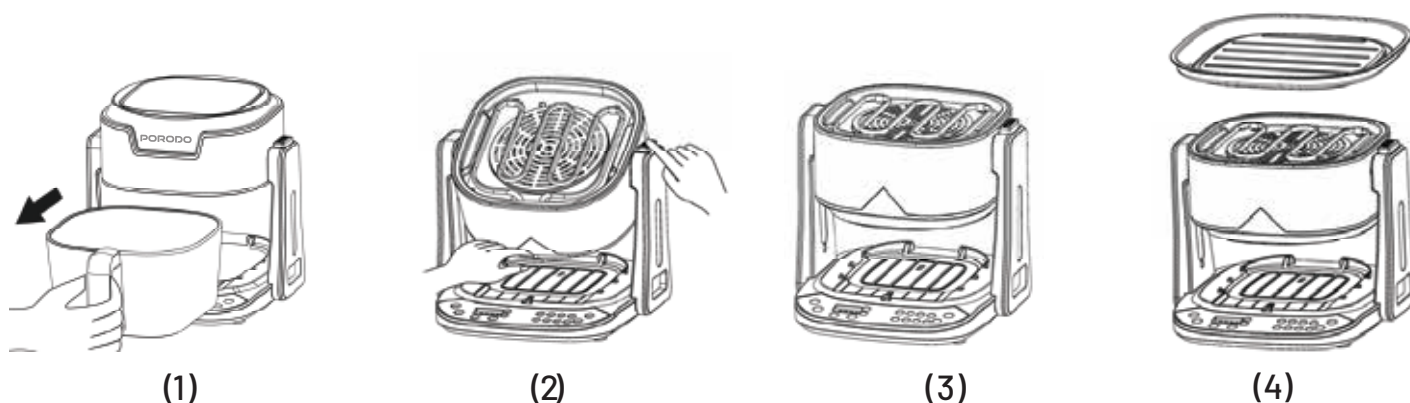

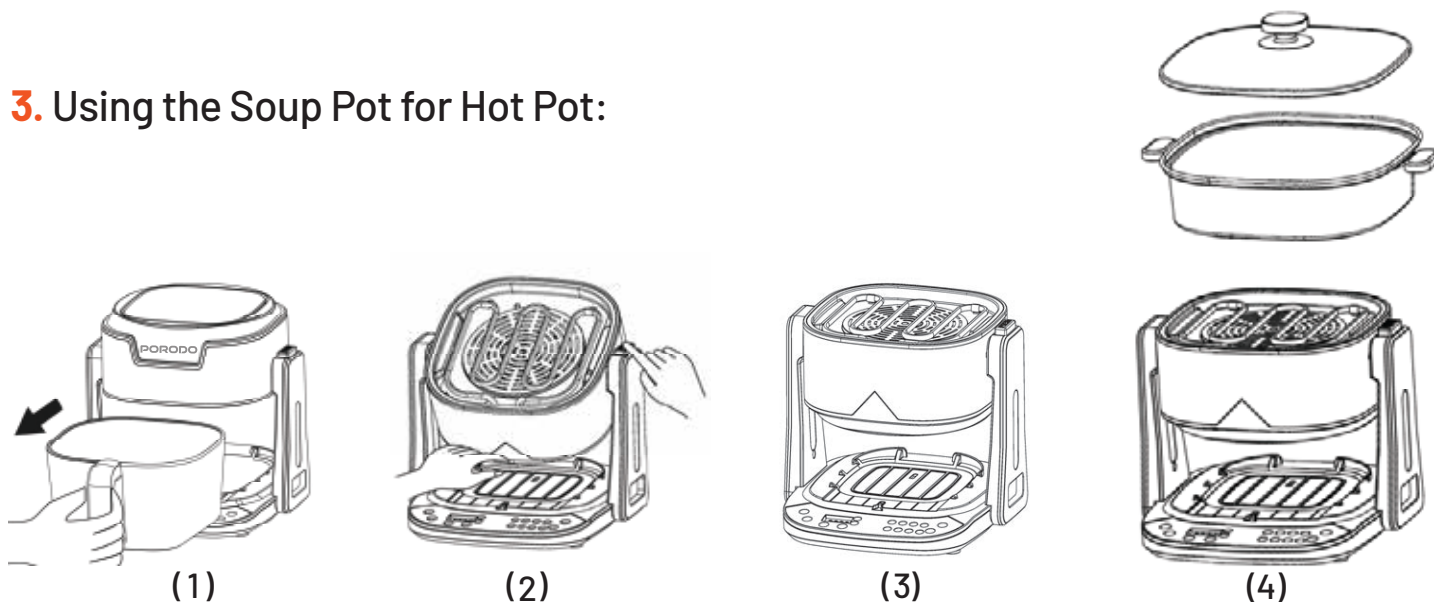

3. Using the Soup Pot for Hot Pot:

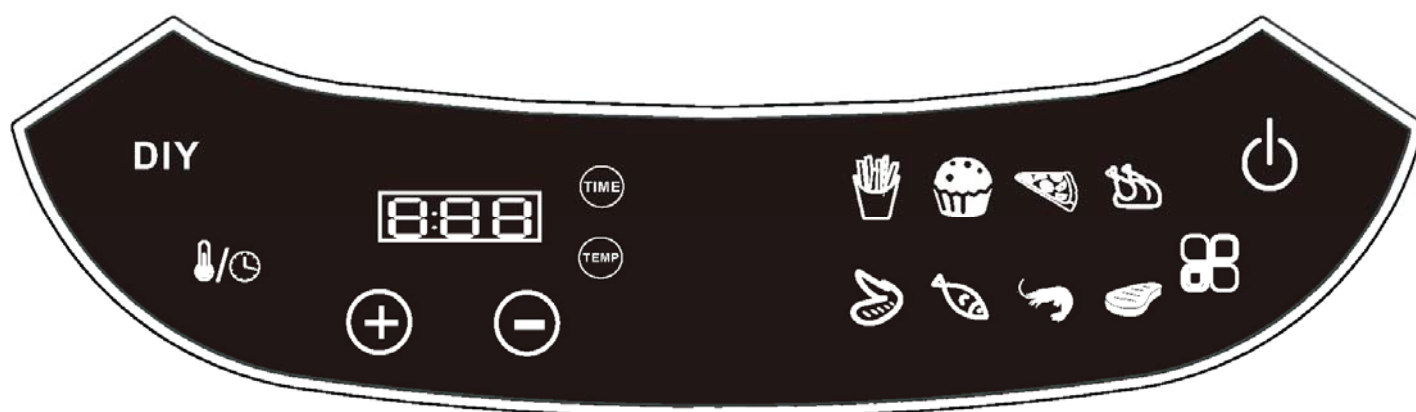

Control Panel Guide



Item	Function
1. 	Turns the appliance On/Off and pauses its operation.
2. 	Switches between different preset cooking modes.
3. <u>DIY</u>	Sets your own recipe.
4. +	Adjusts the timer and temperature.
5. -	Adjusts the timer and temperature.
6. 	Sets the desired cooking temperature and time.

Cooking Guide

1. Choose your desired method for cooking your food, either by using the included mesh rack or grill pan.
2. Add the food to the air fryer. If using the mesh rack, place the food on it before placing it into the air fryer.
3. Insert the power cord firmly into the wall AC outlet.
4. If the glass container is pulled out during the cooking process, the air fryer will pause, and "E5" will be shown on the display. The timer will continue, but the unit will not heat. When the glass container is pushed back in, the cooking process will resume.
5. When the timer reaches zero, the air fryer will make a 'beep' sound to alert you that the cooking process is complete, and the air fryer will stop operating.

Operation Instructions

1. Button ():

1. Press the button () on the control panel to turn the appliance on.

1.2 There are two ways to use the air fryer: one is by using the pre-set menu with cooking times and temperatures, and the other is by manually setting your desired time and temperature.

2. Preset Menu Cooking:





2.1 Press the () button on the control panel.

2.2 Press the () button repeatedly to choose between the different menu cooking options.

2.3 Once your chosen option is displayed on the screen, press the () button on the control panel to start the cooking process.

Menu	Temperature	Time
French Fries	160°C	25 mins
Cake	180°C	30 mins
Pizza	180°C	15 mins
Chicken	200°C	25 mins
Chicken Wings	200°C	20 mins
Fish	180°C	10 mins
Shrimp	180°C	15 mins
Steak	200°C	20 mins

Timer and Temperature Setting

1. Press the () button on the control panel, then press the () button. The temperature will flash on the screen. While flashing, use the + or - buttons on the control panel to adjust the temperature.
2. Once your desired temperature is displayed on the screen, press the () button again, and the time will begin flashing.
3. Use the + or - buttons on the control panel to adjust the time.
4. Once both the temperature and time are set, press the () button on the control panel to begin cooking.



The maximum temperature that can be set is 200°C.

The minimum temperature that can be set is 40°C.

The maximum time that can be set is 1 hour.

The minimum time that can be set is 1 minute.

DIY Cooking Guide

1. Press the () button on the control panel to turn the appliance on.
2. Press the [DIY] button on the control panel.
3. The temperature will start flashing on the screen. While flashing, use the + or - buttons on the control panel to adjust the temperature.
4. Once your desired temperature is displayed, press the () button on the control panel. The time will begin flashing on the screen.
5. Use the + or - buttons on the control panel to adjust the cooking time.
6. After setting the time and temperature, press the () button on the control panel to begin cooking.

The maximum temperature that can be set is 200°C.

The minimum temperature that can be set is 40°C.

The maximum time that can be set is 15 hours.





The minimum time that can be set is 1 minute.

Default Settings:

Default time: 30 minutes

Default temperature: 40°C

Grill or Hot Pot Instructions

1. Press the () button on the control panel to turn the appliance on. The display will show "00:00."
2. Press the [DIY] button on the control panel, then press the () button.
3. The temperature will begin flashing on the screen. While flashing, use the + or - buttons to adjust the temperature.
4. Once your desired temperature is displayed, press the () button on the control panel. The time will begin flashing on the screen.
5. Use the + or - buttons on the control panel to adjust the time.
6. Once both the time and temperature are set, press the () button on the control panel to begin cooking.



The maximum temperature that can be set is 200°C.

The minimum temperature that can be set is 40°C.

The maximum time that can be set is 1 hour.

The minimum time that can be set is 1 minute.

Pause the Operation

1. During the cooking process, press the () button to pause the cooking. Press it again, and the cooking process will automatically resume.
2. If you want to stop the cooking process completely, press and hold the () button. This will stop the appliance from working.

Cooking Table

The cooking times provided are for guidance only and may vary based on factors such as quantity, temperature, and weight.

Food	Temperature	Time
Cashew Nuts	200°C	5–8 mins
Coffee Beans	200°C	20–25 mins
Biscuits	180°C	10–15 mins
Fish Sticks	180°C	6–10 mins
Chicken Nuggets	180°C	10–12 mins
Chicken Breast	200°C	10–15 mins
Chicken Drumsticks	200°C	15–20 mins

Note: For frozen food, please allow additional time based on weight.

Cleaning and Maintenance

1. Unplug the unit and allow it to cool down completely before cleaning or performing any maintenance.

Clean and dry all parts thoroughly after each use.

2. Once the unit has cooled completely, clean the glass container with warm, soapy water and a damp cloth. Avoid using hard objects (such as wire brushes) to clean, as this can scratch the surface and cause rust. The glass container, mesh tray, and grill pan are dishwasher safe.

3. For self-cleaning, add about half an inch of water with mild liquid detergent to the unit.

4. Set the temperature to 60°C, set the timer for 15 minutes, and allow the residue to soften as it heats. Unplug and let the unit cool completely before continuing to clean.

Caution

1. Never immerse the cord or plug in water or any other liquid.

2. If scrubbing is necessary, use a nylon or polyester mesh pad.

3. Avoid using a steel wool pad or any abrasive materials.
4. Do not use solvents or cleaning powders.
5. Ensure no liquid enters the head/lid of the appliance.

Storing

1. Allow the unit to cool completely before storing. Store the appliance in a dry location.
2. Do not place heavy items on top of the appliance during storage, as this may result in potential damage.

Disposal

This product must not be disposed of as unsorted household waste. It is important to separate such waste for proper treatment and recycling, in compliance with local waste management regulations.



Warranty

Products that you buy directly from our **Porodo** website or shop come with a 24-month warranty.

When you buy **Porodo** products from any of our approved sellers, you only get a 12-month warranty. If you want to extend this warranty, go to our website at **porodo.net/warranty** and fill out the form with your information. Don't forget to upload a picture of the product too. After we've checked and accepted your request, we'll send you an email to confirm that your product's warranty has been extended.

For more info, please check:
porodo.net/warranty

Contact Us

If you have any questions about this Privacy Policy, please contact us at:
info@porodo.net

Website: **porodo.net**

Service Support: **support@porodo.net**

Instagram: **porodo**