

porodo | CHOOSE THE BEST



360° ROTATING
AI TRACKING MOUNT

GESTURE RECOGNITION

Model: PD-GAIFTGR-WH

CONTENTS

1. Get to Know the Gimbal	1
1) Bluetooth indicator	2
2) Battery level indicator	2
3) Tracking indicator	2
2. Instruction	4
1) Install the smartphone	4
2) Power button operation	5
3) AI gesture recognize	6
3. Specification	7
4. Get to Know the Remote	8
1) Bluetooth/Battery indicator	9
2) Function button	10
3) Left key	10
4) Right key	10
5. Remote connect to smartphone	11
6. Caution	12
7. Storage & Maintenance	12

1. Get to Know the Gimbal

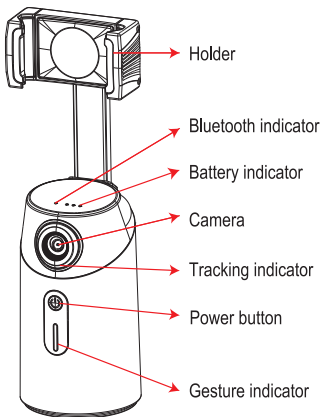

1) Bluetooth indicator

Bluetooth is not connected: indicator is slow flashing

Bluetooth is connecting: indicator is fast flashing

Bluetooth is connected: indicator is on

* The bluetooth indicator is paired with remote, remote will work after it is connected with gimbal.

2) Battery level indicator

The first light is flashing: 1%-3%

The second light is flashing: 4%-50%

The third light is flashing: 51%-99%

The three lights are on: 100%

3) Tracking indicator

Light is on: tracking function is activated and there is face recognized;

Light is slow flashing: tracking function is activated and there is no face recognized;

Light is off: tracking function isn't activated;

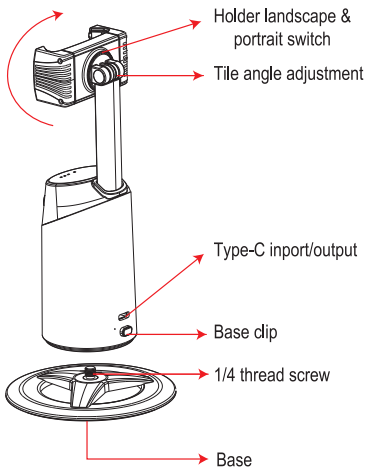

* Press the base clip to rotate and remove the base.

2. Instruction

1) Install the smartphone

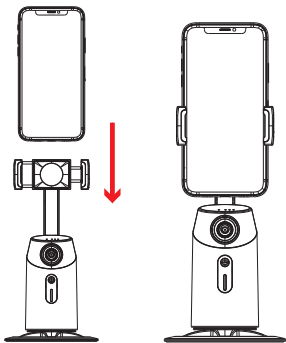

2) Power button operation

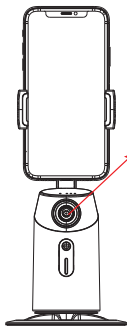

Long press: power on gimbal

Twice press: face tracking
function on/off

Triple press: gesture recognize
function on/off

Press four times continuously:
gimbal will make one turn clock-
wise

* The default face tracking function and gesture recognition function are enabled upon powering on

3) AI gesture recognize

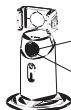

👉 "OK" gesture: turn on the face tracking

👉 "Palm" gesture: turn off the face tracking

* Tips:

1. Gesture recognize distance: 0.5-2.5m is the best;
2. Tracking distance: 0.5-3.5m is the best
3. There is no need to connect bluetooth or download the APP to start tracking;
4. Tracking works in photography, recording, live broadcast and video call;

3. Specification

Model	Z9
Product name	AI tracking gimbal
net weight	269g
Material	PC+ABS
Size	188*58.8*58.5mm 100mm(base)
Support size	Diagonal: 180mm Width: 5-90mm Thickness: 9.5mm
Payload	500g
Battery capacity	4000mAh
Charging method	Type-C 5V/2A

4. Get to know the remote

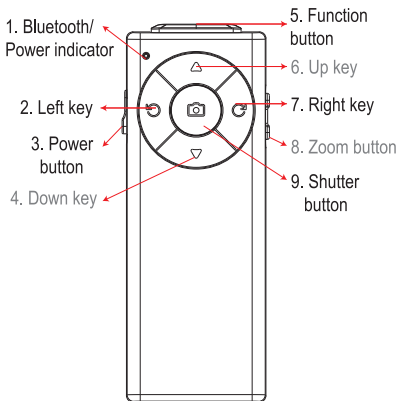

Remarks:

- 1. Functions 4/6/8 are not open in this generation;
- 2. Shutter button works after remote is connected to smartphone by bluetooth.

1) Bluetooth light/Power light

Red: remind to replace the battery in low power

Flashing in blue: remote isn't paired with gimbal

Flash twice time in blue: remote is paring with gimbal

Blue light is on: remote is paired with gimbal

* Remark: the way that remote pairs with gimbal is by bluetooth

Pair steps:

1.Remote and gimbal are in power-off status;

Power on the remote & gimbal at the same time and keep pressing the power button for 5 second until the bluetooth light on remote is on in blue.

2) Function button

Twice press: face tracking function on/off

Triple press: gesture recognize function on/off

3) Left key

Single click: gimbal rotates 3 degrees clockwise

Press continuously: gimbal clockwise uniform rotates

4) Right key

Single click: gimbal rotates 3 degrees

counterclockwise

Press continuously: gimbal counterclockwise uniform rotates

* Press the left key and right key at the same time and hold on for 3 seconds, gimbal will keep turning.

5. Remote connect to smartphone

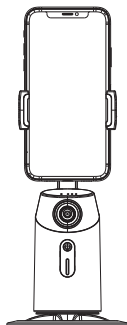

Turn on the smartphone bluetooth, and find the bluetooth starting with "Z9", remote can control smartphone native camera after paired successfully.

6. Caution

1. Ensure the motor rotation is not blocked by external force during and after the gimbal is powered on;
2. Please do not contact with sea water or corrosive liquid;
3. Please do not disassemble the gimbal (except for the detachable accessories in the manual);
4. If the motor works continuously for a long time, the surface temperature of the motor may be too high.
5. It is strictly forbidden to drop or collide with the gimbal, which may damage it and cause abnormal operation.

7. Storage and maintenance

1. Please keep this product away from children and pets;
2. It is forbidden to put the product near the heat source (furnace or heater, etc.) and in the car at hot weather;
3. Please store the product in a dry environment;
4. Do not overcharge or discharge the battery, otherwise the battery cell will be damaged;
5. Do not use the product in the environment with too high or too low temperature;.

www.porodo.net

 [/porodo](https://www.instagram.com/porodo)

 [/myporodo](https://www.facebook.com/myporodo)

For more information, please contact our support team support@porodo.net

Made in China

