

porodo



Gimbal P10 PRO

3-Axis anti shake - SKU: PD-3AXGMP-GGY

Table of Content

Quick Start.....	2
Powering the Device ON and OFF	3
Bluetooth Connection	4
Instructions for Operation Modes.....	4
Schematic View of Porodo Gimbal P10 PRO	7
Switching Between Horizontal/Vertical Mode	11
Charging the Gimbal.....	14
App Connectivity.....	15
Specifications.....	16
Caution.....	17
Storage and Maintenance.....	17
Warranty.....	18
Contact Us.....	18

Quick Start

To install the smartphone and adjust the balance of the phone follow these steps:

(Note: No need to turn on the Gimbal)

1. Remove the smartphone case before installation.
2. Place the smartphone in the phone holder, ensuring it is centered.
3. Secure the smartphone in the phone holder.
4. Adjust so that the smartphone counterbalances the motor, as illustrated, to minimize vibration during use.

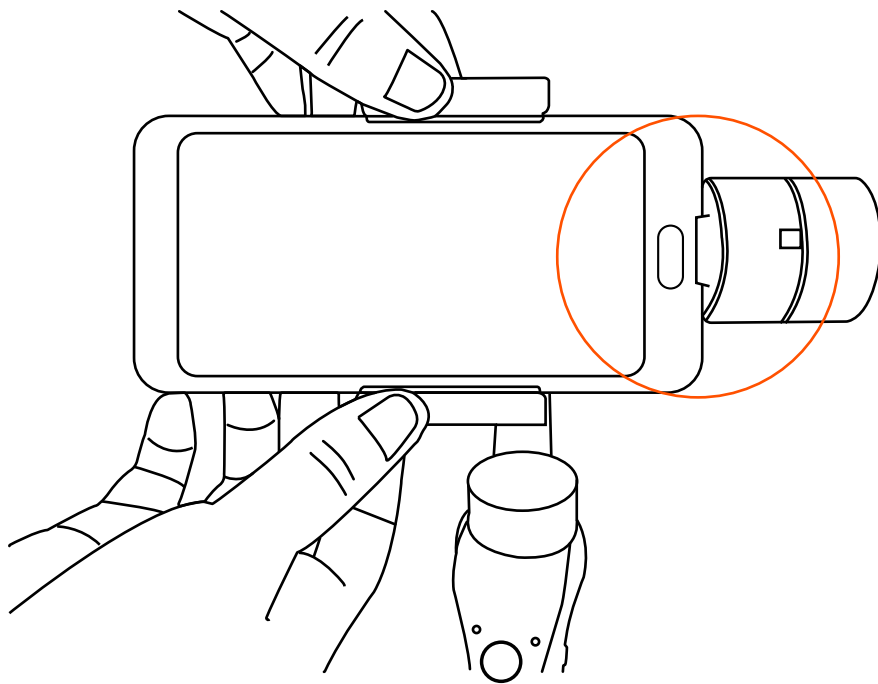

5. To re-adjust the phone loosen the balance knob. Adjust the balance arm until the smartphone is suitably balanced.

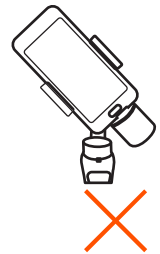
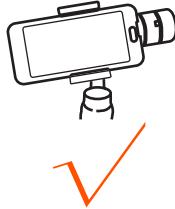
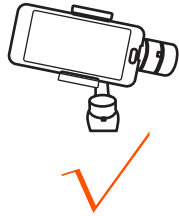
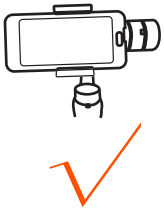
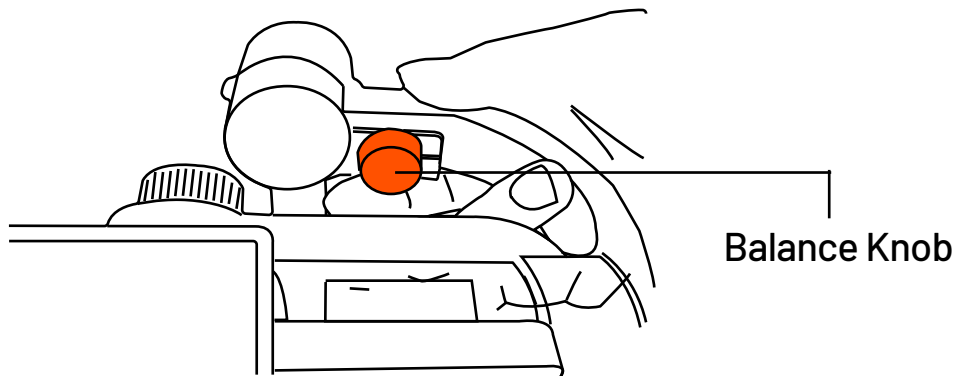

Powering the Device ON and OFF

Power ON

Press and hold the power button until the indicator lights turn on.

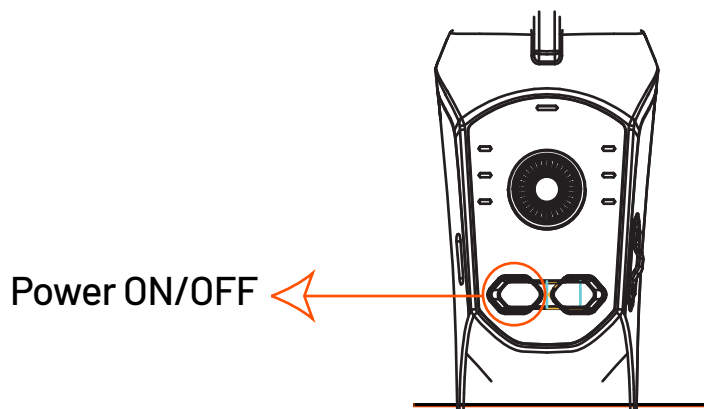

Power OFF

Press and hold the power button until the indicator lights turn off.

Bluetooth Connection

1. Turn on the device
2. Activate Bluetooth on your phone.
3. Navigate to the Bluetooth settings on your smartphone.
4. Select the device named "GP5_XXXX" to pair and connect.

Instructions for Operation Modes

All Follow (AF) Mode

The Roll axis remains stationary. The Pan axis moves left and right while the Tilt axis has upward and downward motion to ensure precise tracking of the motion handle.

Note: This is the default mode upon turning the device ON.

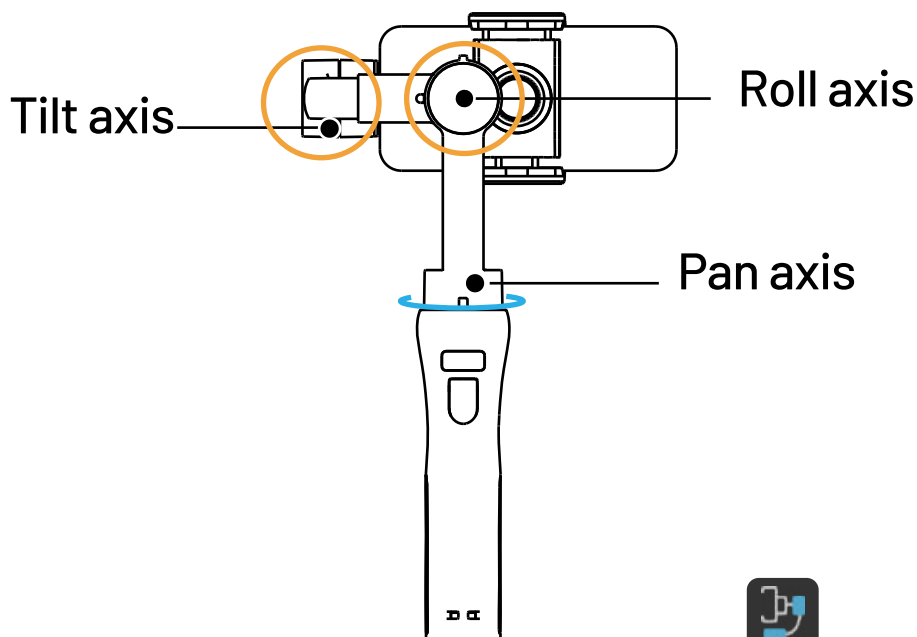

Half Follow (HF) Mode

The Tilt and Roll axes are fixed. The Pan axis moves smoothly left and right in sync with the handle's movement.

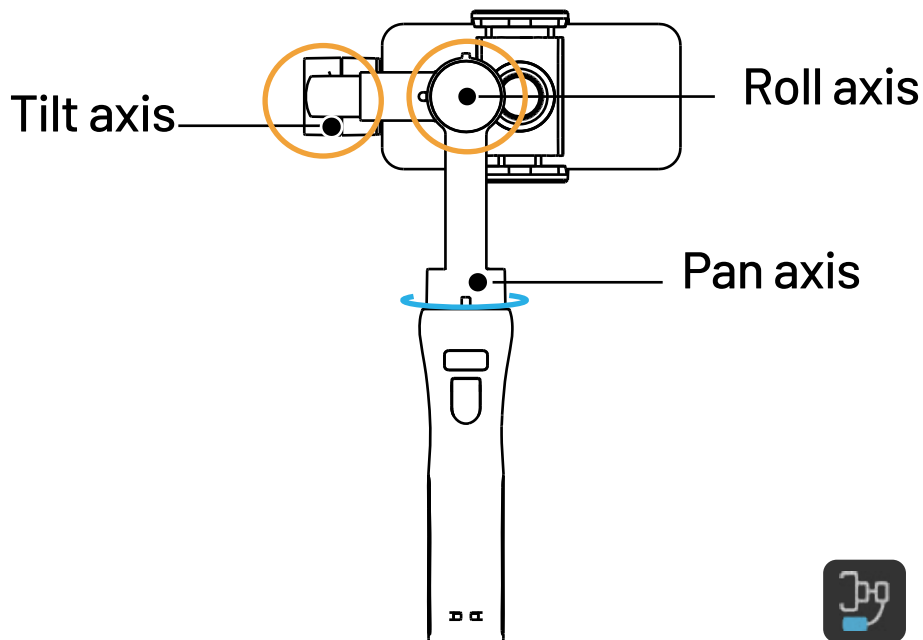

Lock Full (LF) Mode

In this mode, the Pan, Tilt, and Roll axes are fixed.

The camera remains stationary, not tracking the handle's movement.

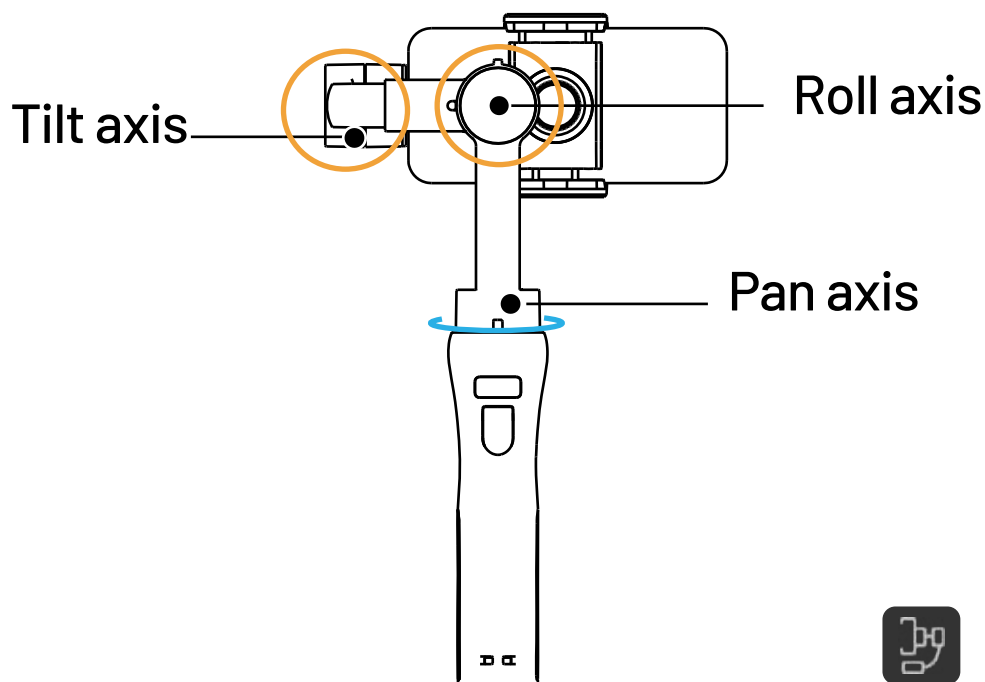

First Person View (FPV) Mode

The Pan, Tilt, and Roll axes follow the movement of the handle, providing a first-person perspective.

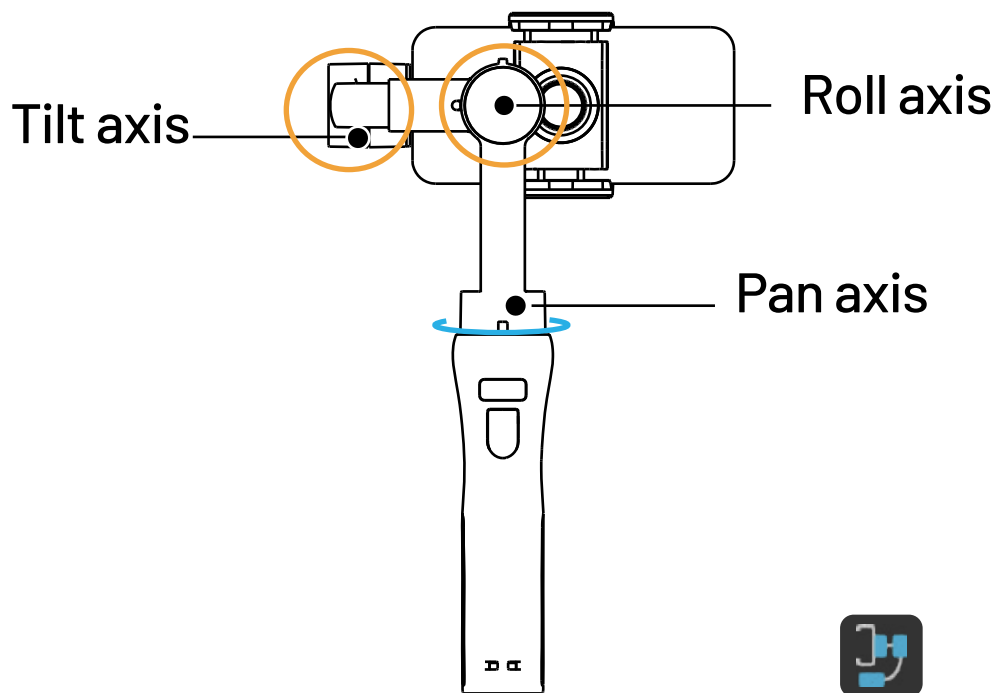

Phone Go Mode

To activate the phone Go mode , press and hold the shutter button until the AF light starts flashing. Releasing the shutter button deactivates the Phone Go mode.

Schematic View of Porodo Gimbal

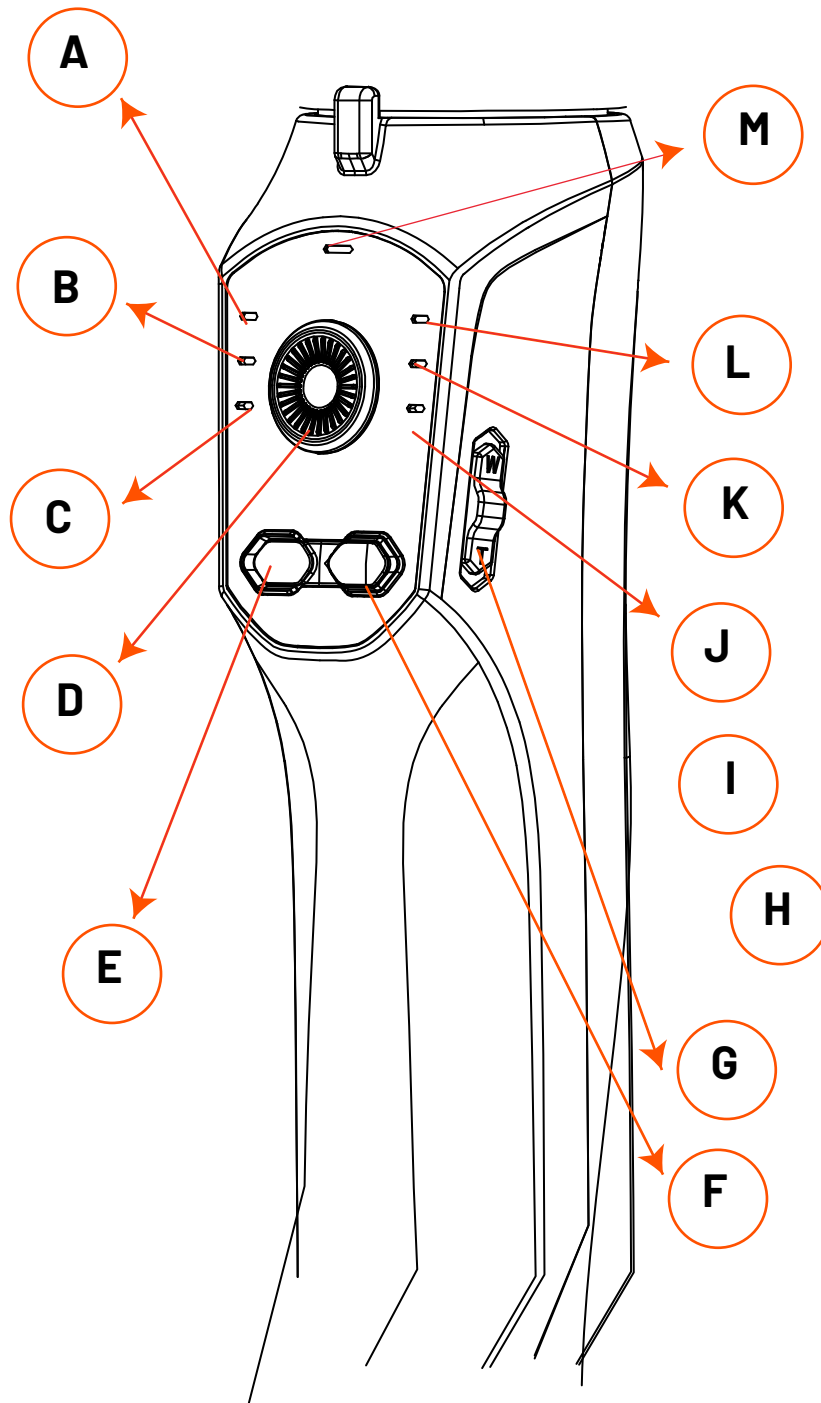

A: Battery Level Indicator
High level (67%-100%)

B: Battery Level Indicator
Middle level (34%-66%)

C: Battery Level Indicator
Low level (1%-33%)

D: Joystick
Control the orientation of Gimbal Pro by maneuvering the joystick upward, downward, left, and right direction.

E: Power Button
(1) Long pressing the button turns the device ON and OFF.
(2) Double press the power button to switch between front-facing and rear-facing cameras.
(3) Triple pressing the button switches between video/photo mode.
(To use this feature connect the device to "Gimbal Pro" App)

F: Mode Button
(1) Single press: Switch between four modes.
(2) Double press: Recenter the gimbal.
(3) Triple press: Switch between portrait/landscape mode.

G: Zoom
Use this button to operate the zoom feature.

H: Phone Go mode
AF light is flashing.

I: FPV Mode
All AF, HF, and LF lights are on.

J: LF Mode

Lock full (LF) mode is activated.

K: HF Mode

Half follow (HF) mode is activated

L: AF Mode

All follow (AF) mode is activated.

M: Bluetooth Connection Indicator

(1) Flashing slowly means that the Bluetooth is not connected.

(2) Flashing rapidly indicates that Bluetooth is connecting.

(3) Solid light is when Bluetooth is successfully connected.

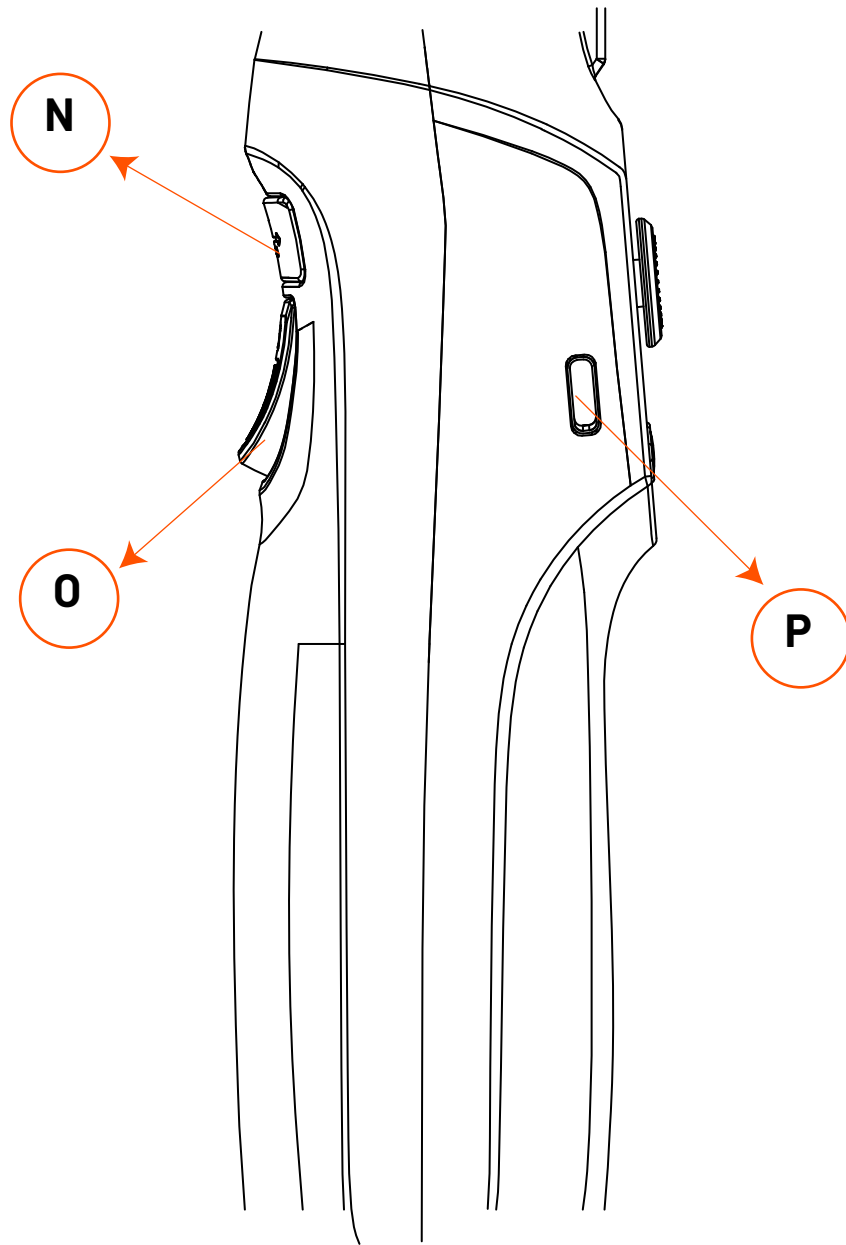

N: Output Port

Use this port to charge the smartphone.

O: Shutter Button

(1) Single press: Captures a photo or starts recording video (To use this feature connect the device to "Gimbal Pro" App).

(2) Long press: Activates Phone Go mode.

P: Input Port

Use this port to charge the device.

Switching Between Horizontal/Vertical Mode

There are three different methods to switch between horizontal and vertical modes

Method 1: Pressing the Power Button

1. Position the gimbal as shown in the picture.
2. Press the power button three times to switch from horizontal to vertical mode.
3. Press the power button three times again to switch back to horizontal mode, or the gimbal will revert to horizontal mode automatically when held upright.

Note: This method is not applicable in FPV mode.



Press the power
button three times



Method 2: Gesture Control

1. Hold the gimbal perpendicular to the ground.
 2. Tilt the gimbal 70° left or right to switch orientation.
 3. The gimbal automatically switches to vertical mode.
 4. It will return to horizontal mode when held upright.
- Note:** This method is not applicable in FPV mode.

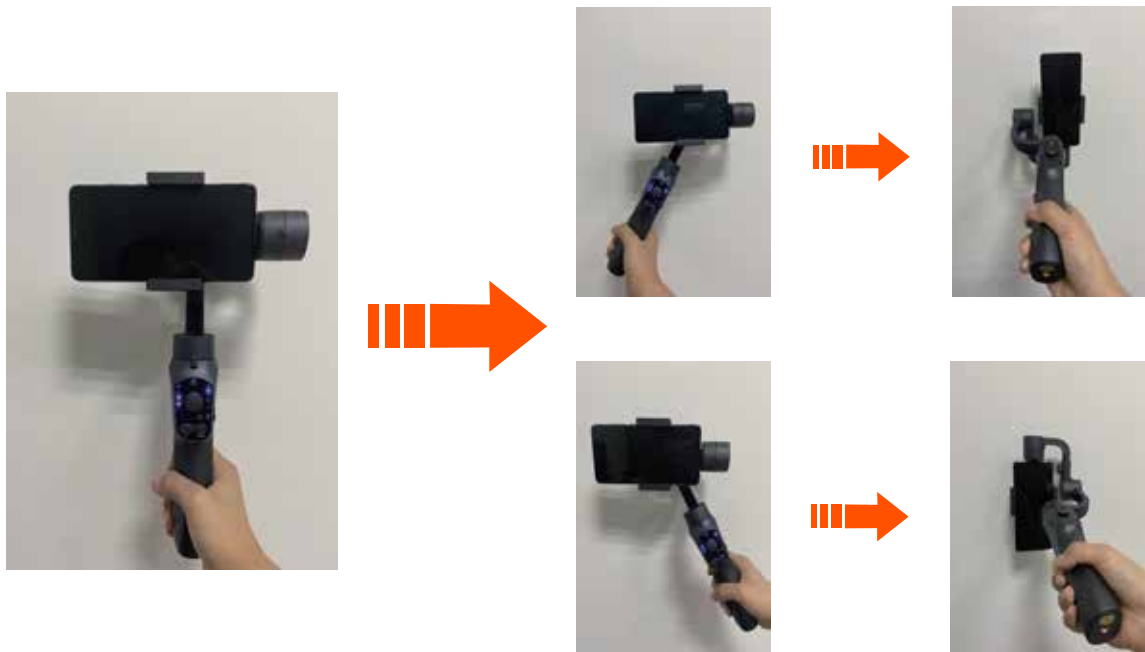

Method 3: Rotate the Smartphone Clamp

1. Loosen the clamp knob.
2. Rotate the smartphone clamp by 90°.
3. Secure the phone by tightening the clamp knob.



Charging the Gimbal

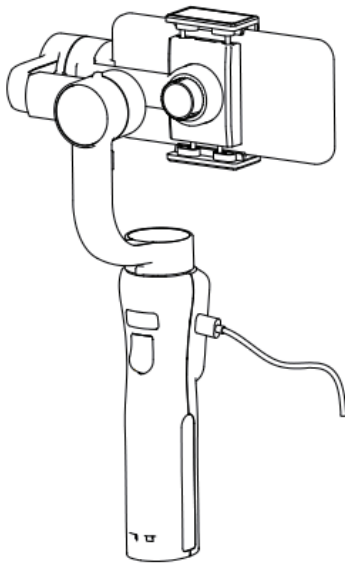

Charging the gimbal

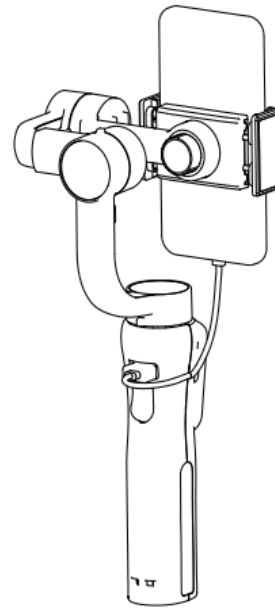

Charging the smartphone

To charge the smartphone follow these steps:

1. Place the phone inside the clamps as shown in the picture.
2. Use a Type-L charger to connect the smartphone to the gimbal.

App Connectivity

Porodo Gimbal is capable of performing primary tasks such as taking a simple picture without the App connectivity. However, various options, including the zooming feature, panoramic view, and time-lapse feature, are only provided via the Gimbal Pro App.

To download and install the App, scan the following QR code or search for "**Gimbal Pro**" on Google Play or App Store.

Enable Bluetooth connectivity on your phone. Install the App on your smartphone. Start the App and find and connect to the device named "**GP5_XXXX**".



Android / iOS

Specifications

Tilt angle	330°
Roll angle	180°
Pan angle	330°
Weight	440 gr
Payload	75 – 250 gr
Operating temperature	0° to 40° C
Controllable tilt angle	-155° / +155°
Controllable roll angle	-30° / +30°
Controllable pan angle	-155° / +155°
Working voltage	3.4~4.2 V (Standard 3.7 V)
Compatible smartphone range	Width: 6 to 8.5 cm Length: ≤ 16.5 Weight: ≤ 250 gr
Working current	150~3000 mA (Standard 1500 mA)
Gimbal dimension	10.8×7×28.9 cm
Charging time	4 Hr
Working time	8 to 10 Hr
Face tracking	YES
App	YES
Zoom	YES
Output/Input current	1 A
Output/Input voltage	5 V
Arm material	PPA+Nylon
Handle material	ABS+PC

Caution

1. Ensure that the motor's rotation is not impeded by any external forces when the stabilizer is switched on.
2. Avoid exposing the stabilizer to seawater or corrosive liquids.
3. Do not disassemble the stabilizer, except to attach or detach accessories specified in the manual.
4. If the device is in use for an extended period, its surface temperature may become elevated.
5. It is essential to prevent dropping or striking the stabilizer, as such impacts can lead to damage and disrupt normal functioning.

Storage and Maintenance

1. Ensure this product is kept out of reach of children and pets.
2. Do not place the product near any heat source, such as furnaces or heaters, nor leave it in a vehicle during hot weather.
3. Store the product in a dry environment to prevent damage.
4. Avoid overcharging or completely discharging the battery as it can lead to damage.
5. Operate the product within a temperature range that is neither too high nor too low to ensure its proper functioning.

Warranty

Products that you buy directly from our Porodo website or shop come with a 24-month warranty. When you buy Porodo products from any of our approved sellers, you only get a 12-month warranty. If you want to extend this warranty, go to our website at <https://porodo.net/warranty> and fill out the form with your information. Don't forget to upload a picture of the product too. After we've checked and accepted your request, we'll send you an email to confirm that your product's warranty has been extended.

For more info, please check:
porodo.net/warranty

Contact Us

If you have any questions about this Privacy Policy, please contact us at: info@porodo.net
Website: porodo.net
Service Support: support@porodo.net
Instagram: [porodo](https://www.instagram.com/porodo)