

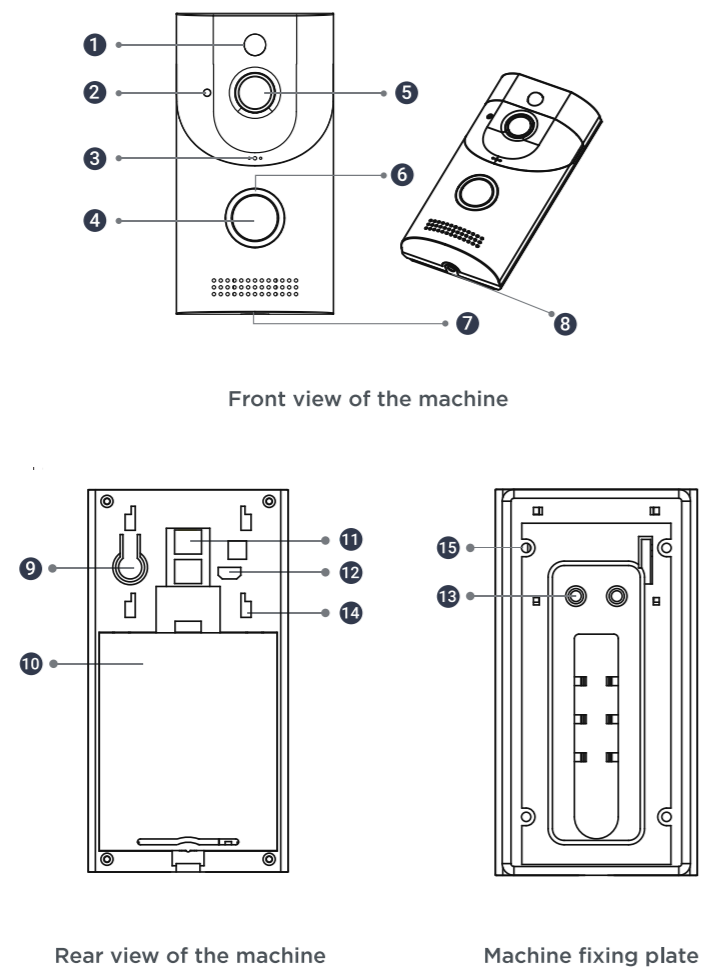

1. Component Identification



2. Product Information

- 1 **Motion sensor:** Detects movement, when someone walks in front of the doorbell, the user receives a notification.
- 2 **Infrared night vision:** Provides clear video quality in the mobile app when it is dark.
- 3 **Microphone:** Through the two-way conversation you can communicate via your mobile with the person standing at the door.
- 4 **Doorbell button:** When someone presses the doorbell button, the user receives a notification and the doorbell chimes ring.
- 5 **Lens:** If the blue button is blinking slowly, it means that the doorbell is waiting for a Wi-Fi connection. When you press the doorbell and the button turns blue, it means that the doorbell is connected. When you press the doorbell and the button is red for 10 seconds, it means that the connection has failed.
- 6 **Indicator:** If the blue light flashes slowly, it means the system is waiting for WiFi configuration. When press the doorbell, with blue light stays on 5 seconds, it means the system is in normal working condition. When press the doorbell, with red light stays on 10 seconds, it means failed to connect to system WiFi.
- 7 **Speaker:** Audio
- 8 **Anti-theft hole:** Mount the mounting plate in the anti-theft hole and this will prevent the doorbell from being stolen.
- 9 **Reset button:** Press and hold the reset button for 5 seconds to return to the factory settings.
- 10 **Battery input:** Ensure that the tabs are removed from the battery.

- 11 **External power supply:** Connect the external power supply to the doorbell to always receive power.
- 12 **USB port:** To charge the doorbell with a USB power cord.
- 13 **External power opening:** Connect it to the main voltage in the wall to power the device
- 14 **Mounting plate entrance:** Carefully slide the mounting plate away from the doorbell.
- 15 **Mounting hole:** Ensure that the security screws are mounted correctly.

How do you mount the doorbell on the power grid?

Remove the original doorbell and screw the 2 power cables into the two different holes (point 13) and tighten the screws securely with the cables around it. Then drill 4 holes in the wall / door and make sure that the screws fit in the mounting plate (point 15).

3. Installation

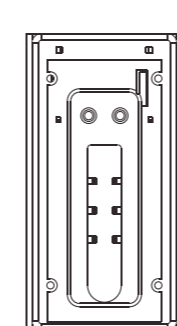

- Step 2
- Mount the Mounting plate on the wall**
- Mount it using the screws included in the product package. You can also use the 3M sticker to attach the mounting plate to the wall / door.
 - Connect the doorbell to the power supply by means of the electric cables of your previous doorbell

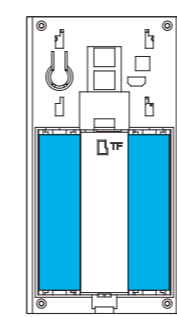

- Step 3
- Install the batteries**
- After removing the tabs are removed from the batteries.
 - You can place a memory card in the doorbell to save recorded videos permanently. (Memory card not included).
 - After removing the tabs from the batteries, make sure you press and hold the reset button for 5 seconds.
 - Replace the cover on the batteries and continue to connect to the mobile app.

4. Download the Mobile App - TuyaSmart

Scan the QR codes below to download the mobile app on your android or iOS device, or download the app from Google Play store or App store.



5. App Functions

- The TuyaSmart app performs a number of management functions for smart video doorbells.
1. Adding and deleting of doorbells: You can connect and add more than one doorbell on the mobile app.
 2. Configure the smart doorbell connection using the Wi-Fi network on app.
 3. Receive push messages and notification on the app, including doorbell call, motion detection (PIR) and push information management function.
 4. Connect the video doorbell to the app, which will enable you view the camera footage from the doorbell, screenshot and local recording function.
 5. TuyaSmart enables you to share the video footage with other family members.
 6. TuyaSmart doorbell setting functions, including power management settings, basic functions settings, motion detection settings, memory card settings and software upgrades.

6. App Welcome Screen

Download and install TuyaSmart app on your mobile device, open app and it will display this interface.

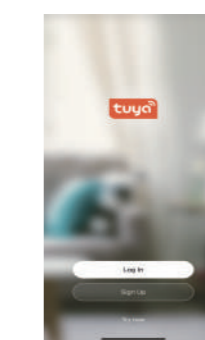

7. User Register

If you have an existing account, simply click "Login" and Input your login details. If you don't have an account, click on "Register" and follow the required steps to register on the app.

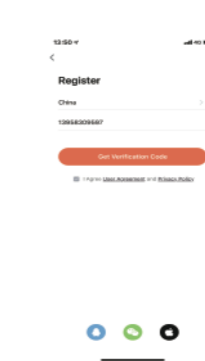

8. Add Device

After logging in, select the device type and video surveillance. Then, sync the doorbell with the mobile app.

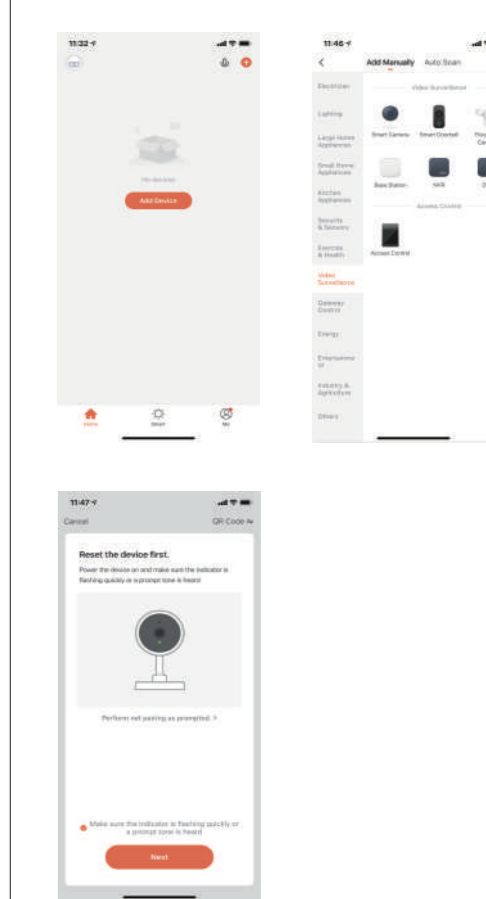

9. General Connection

Power on the device, the Indicator light should blink red light rapidly. If it does, click "Confirm indicator rapidly blink".

Enter your Wi-Fi password in the specified box and press confirm, then wait for the device connection to be established, the device will show blue light to indicate that the connection process is in progress. Then, name the doorbell.

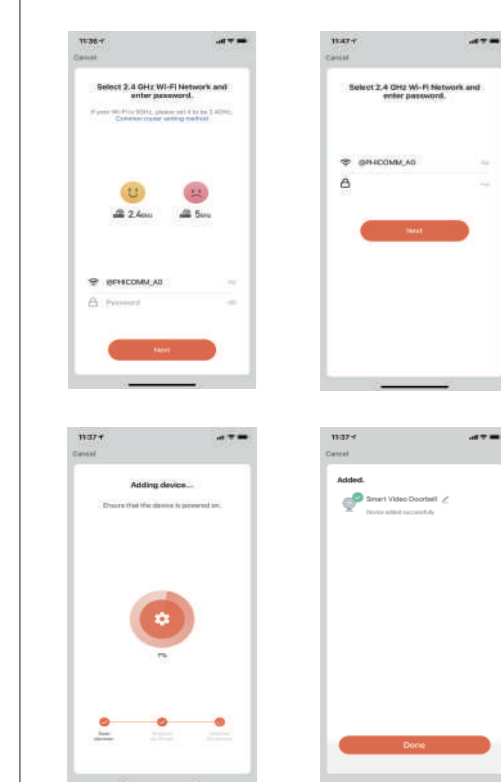

10. QR Code Connection

Power on the device and click "QR Code" on the top right corner of the screen, the Indicator light should blink red light rapidly. If it does, click "Confirm indicator rapidly blink".

Enter your Wi-Fi password in the specified box and press confirm, a QR Code will be generated on the app, scan the code using the doorbell camera, then wait for the device connection to be established, the device will show blue light to indicate that the connection process is in progress. Then, name the doorbell.

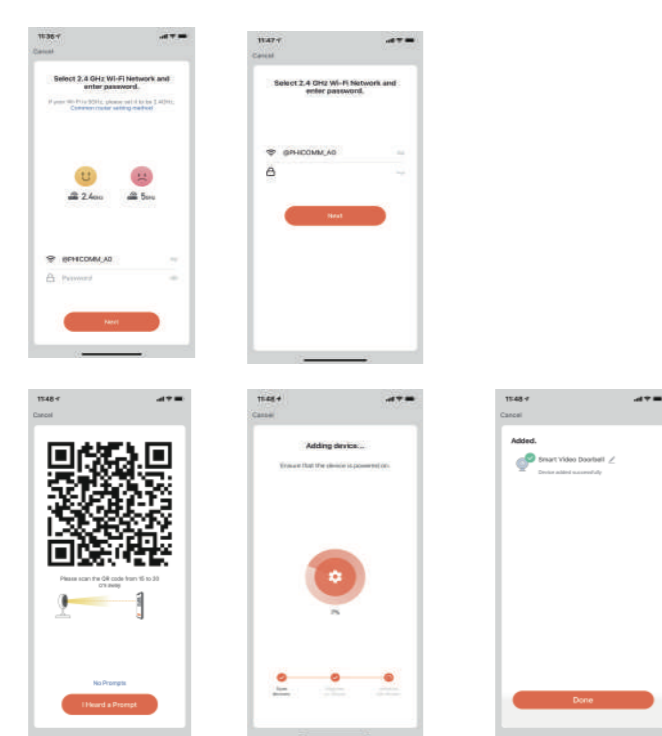

11. Device Connection Status Description

- 1. **Red light blinking continuously:** The device is ready to connect network mode.
- 2. **Red light flashing once in 1s:** The device has entered network connection mode. If it successfully connects with the app or detects QR code, you will receive a notification tone. The device may fail to enter network connection mode if,
 - The Wi-Fi router does not support broadcast transmission, in this case, change the mode of connection to QR code.
- The QR code scanning fails, in this case, increase the brightness of your mobile device and put it directly in front of the door bell camera lens to rescan it
- 3. **Blue light blinking continuously:** The device has connected. The device may fail to connect with network if,
 - You configured the correct Wi-Fi account but entered the wrong password, the device will not connect, in this case reconfigure the network and enter the right password.
- The device has been connected to a n other user's smart phone, in this case, delete the device and reconfigure the network.
- 4. **Red and blue light blinking alternately:** The device is in standby mode, if after wake up status, the light remains unchanged, the device has failed to enter connection mode.
- 5. **Blue light flashing once in 1s:** The device is in standby mode, if after wake up status, the light remains unchanged, the device successfully connected to the network.

12. Live View Description

The device list on the mobile app shows all the devices that are connected to the network. Select the doorbell device name to view live recording directly. This interface supports the following

function: Two-way Audio, Video recording to local file, screenshot, playback video on TF card.

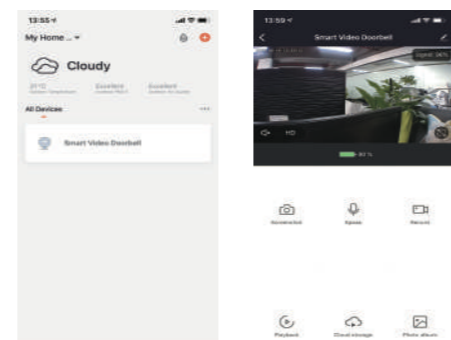

13. Device Management

Click "Z" on live view page to enter device management (settings page). Click "Z" on live view page to enter device management (Settings pages).

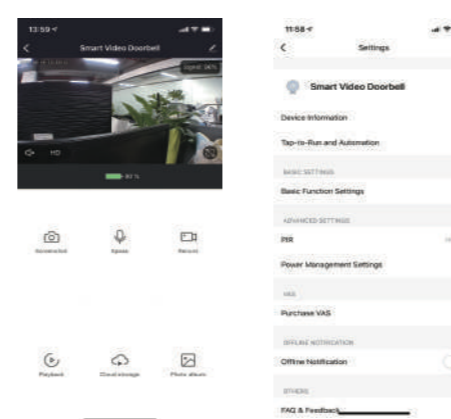

14. Modify Device Name

Click "Modify device name" on settings page to rename the doorbell device.

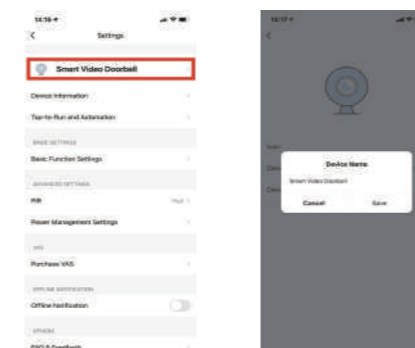

15. Device Sharing

Click "Device sharing" on settings page to share with other family members, simply provide the intended user's mobile number or email.

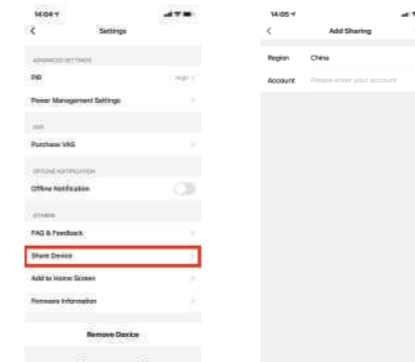

16. Device Info

Click "Device info" on setting page to check device information

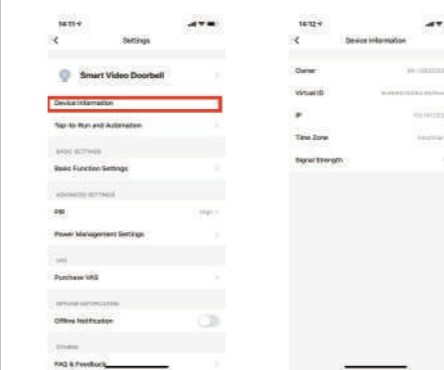

17. Power Management Status

Click "Power manage" to check and manage the power status of the doorbell.

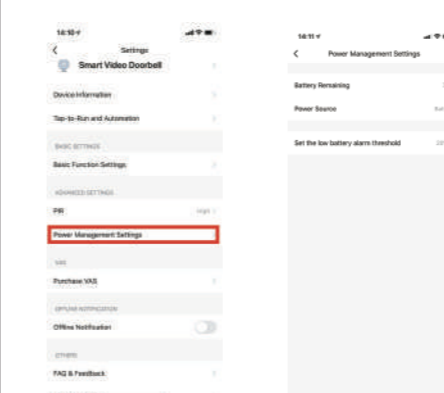

18. Basic Function Setting

Click "Basic function setting" to set the below functions: Indicator light, Flip (Mirror Image), Time watermark, WDR mode and IR night vision.

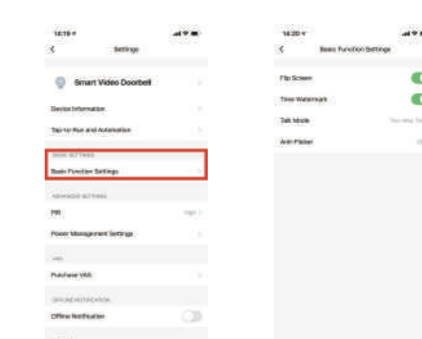

19. Motion Detection Setting

Click "Motion detection setting" to turn on motion detection alarm and set the sensitivity level.

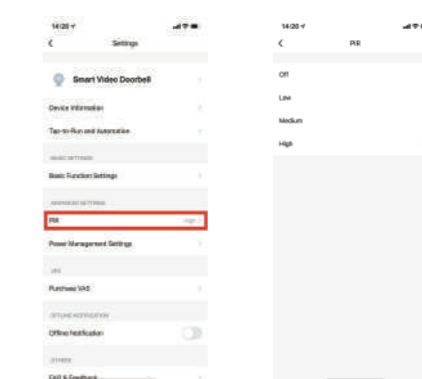

20. SD Card Setting

Click "SD card setting" to check the SD card storage analysis, turn on/off SD card video recording or format memory card.

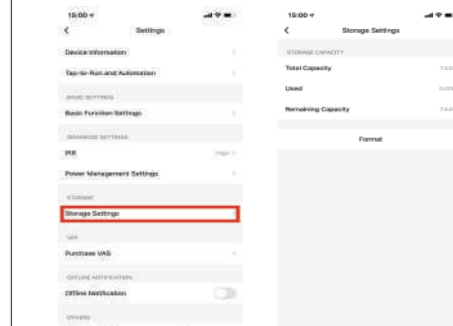

App Receives Push Notification

21. Doorbell Call

When someone presses the doorbell and it rings, the doorbell will place a call to your smartphone to notify you. Select "Accept" to view the recording image or "Reject" to reject the call.



22. PIR Motion Detection Push Notification

When someone stays in the camera view of the doorbell or the device detects movement, it will start recording send a push notification to your smartphone

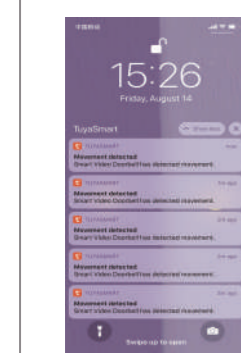

23. Message Center

Click "Message center" on app to check push notification history.

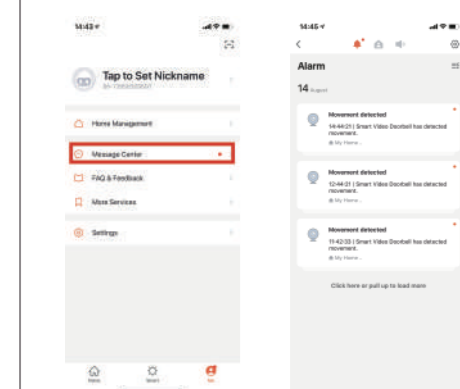

24. Setting

Click "setting" to set Sound, Push notification, etc.

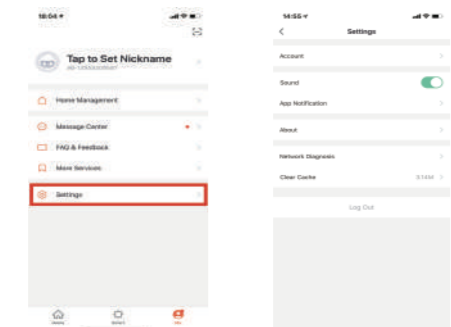

25. Specification

Resolution	1280*720
Angle	170 Degrees
Infrared Light	6X850mm
Wi-Fi	Support 2.4G networks
Audio	Supports Two-Way audio
Video	SD-Card (15 seconds)
Storage	8G/16G/32G
Battery	2X18650 batteries
Notification	Within 2 seconds
Wake-up time	Within 600 minutes
Wake-up Methods	Doorbell ring Motion detection
Standby	200uA
Power Usage	170mA

26. FAQs

- Q: How do I turn off the anti-theft alarm?**
 1. Slide the doorbell onto the mounting plate so that the alarm sounds.
 2. Slide the doorbell off the mounting plate, you will receive a notification message in the app.
 3. Slide the doorbell back onto the mounting plate and then click on the message in the mobile app.
 4. Wait a moment and let the alarm go off for 1 to 2 minutes, then it should stop.
- Q: How long does the images stay in the cloud?**

A. The recorded images will stay on the device and the cloud for 7 days. To permanently save the images, place an SD card in the doorbell. If it is full, the doorbell will automatically overwrite the oldest images.
- Q: Motion detector goes off all the time, what can I do about it?**

A. Check if there are any objects that can move near the doorbell, for example a tree or shrub that moves by the wind. The PIR can also go off frequently on busy roads. If this is the case, you can set the PIR sensitivity to the lowest level or switch it off.
- Q: Doorbell does not connect to the Wi-Fi. How can I solve this?**

A. Make sure you are connected to a 2.4G network. Also make sure that the sound from your mobile is switched on when connecting to the doorbell. During the connection, your mobile transmits sound waves.
- Q: How many people can use the wireless doorbell?**

A. 4 people can watch the video at the same time but only 1 person can use the intercom.

Q: Battery drains quickly. What can I do about this?

A. You can connect the Look Video Doorbell to the power grid. You do this by connecting the original wires (two pieces) of your traditional doorbell to the two screws on the mounting plate. If you do not have any original wiring, you can purchase a 12-24v adapter for the wall socket. Setting the PIR motion detector to a lower position also saves battery.

Q: Why does the app image load so slowly?

A. The doorbell can be placed too far from the router or there are obstacles in the way between your router and the doorbell. If this is the case, you can purchase a Wi-Fi amplifier and place it near your doorbell.

Q: How do you connect the doorbell with the inner bell/chime?

A. Hold the button above the volume button for 5 seconds until the LED indicator lights up blue. Then press the doorbell button.

Q: How do I select my favorite melody?

A. Choose one of the melodies that you want. Then press the button above the volume button for 5 seconds. When the LED indicator lights up blue, press the button on your doorbell.

Download the App /

Télécharger l'APP



Available at

Disponible à

